

## liniLED® Line Profile 40 mm

Create beautiful light lines in walls and/or ceilings with the liniLED® Line Profiles 40 mm. Depending on the desired effect, you can choose between diffuse or clear acrylic. Related accessories are the end caps and mountingclips.

The Line Profiles are available in white in standard lengths of 1, 2 and 3 metres. Other anodised colours on request.

For the latest version of this datasheet, visit our website:  
[www.liniLED.com](http://www.liniLED.com).



To be used with:



## General Product Characteristics

### Line Profile 40 mm

Product code	10985 (1 m), 12815 (2 m), 12816 (3 m) 12817 (4 m)
Appearance	Aluminium Profile with acrylic diffuser
Size	W44 x H51 mm
Length	1000 mm, 2000 mm, 3000 mm, 4000 mm
Colour	White (RAL 9010) (other RAL colours on request)
Material	Aluminium Alloy 6060
Finish	Powder Coated
Recommended	Use the liniLED® U-Profile to fixate the LED strip (art. 11369).

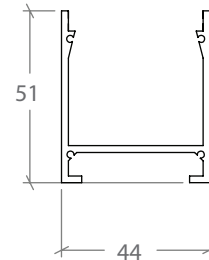

### Acrylic 40 mm

Product code	10961 (1m), 12820 (2m), 12821 (3m) - frosted 10967 (1m), 12825 (2m), 12826 (3m) - clear
Size	W40 x H6 mm
Length	1000 mm, 2000 mm, 3000 mm
Max length	3000 mm
Materials	Acrylic
Appearance	Diffuse (frosted) or clear

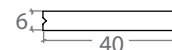

### End cap

Product code	10971
Dimensions	W44 x H51 mm
Colour	White (RAL 9010) (other RAL colours on request)
Material	Aluminium Alloy 6060
Finish	Powder Coated
Included	Screws

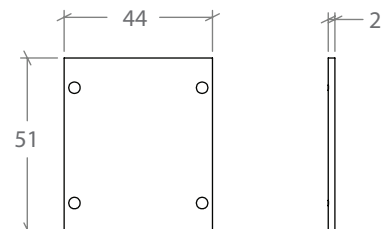

### Mounting Clip

Product code	10979
Dimensions	Ø 35 mm
Colour	White
Material	Nylon

